

REV	ECN	APP'D
-	4520	IQ 8/21/01
A	4728	IQ 1/24/02
B	5742	RN 12/28/05

# ELFP SERIES PART NUMBERING SCHEME

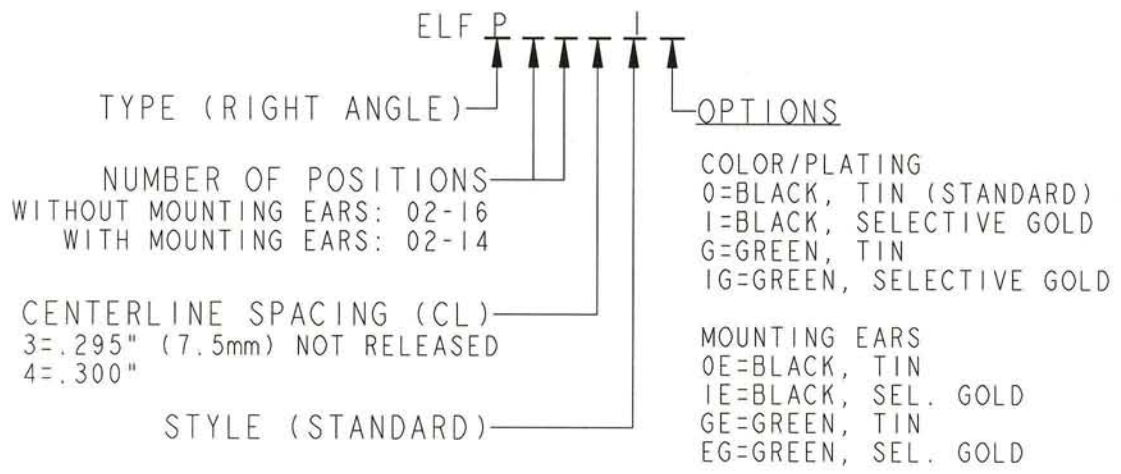

**RU RATINGS**  
**CURRENT - 15A**  
**VOLTAGE - 300V**  
**U.L. FILE NO. PENDING**

**SP RATINGS**  
**CURRENT - 15 A**  
**VOLTAGE - 450 V**  
**CSA FILE NO. PENDING**

**DIN VDE 0627:1986**  
**DIN VDE 0110-1:1989**  
**EN 60947-1:1991**  
**EN 60947-7-1:1992**  
**CURRENT - 15 A**  
**VOLTAGE - 450 V**  
**TUV FILE NO. PENDING**

**INSTALLATION RECOMMENDATIONS:**  
**WIRE RANGE: AWG #14-26, STRANDED OR SOLID; AWG #12 STRANDED**  
**WIRE STRIP LENGTH: .310"**  
**TIGHTENING TORQUE: 7 LB-IN.**

**MATERIALS:**  
**HOUSING: PPO, UL 94 V-0**  
**CONTACT: COPPER ALLOY, OPTIONAL FINISH**  
**SCREW: STEEL, NICKEL FINISH**  
**WIRE CLAMP: COPPER ALLOY, NICKEL FINISH**

**MAX OPERATING TEMPERATURE: 105°C**

<b>DIMENSIONS</b> ANSI Y14.5M UNITS: INCHES Pro/E FILE	<b>TOLERANCES</b> .XX ±0.01 .XXX ±0.005 ANGLES ±1.0°	<b>PROJECTION</b> 	<b>Amphenol Pcd</b>		<b>TITLE</b> <b>ELFP SERIES PLUG RIGHT ANGLE 7.5mm/.300 PITCH</b>		
			<b>ENGR</b> S.HORNER 30-Jul-01				
<b>ORIGINAL STAMPED IN RED</b>	THIS DOCUMENT CONTAINS PROPRIETARY INFORMATION WHICH IS THE CONFIDENTIAL PROPERTY OF AMPHENOL PCD, INC. PEABODY, MA, USA		<b>CHKD</b> IAN QUINN 21-AUG-01		<b>SIZE</b> <b>A</b>	<b>DWG NO.</b> <b>ELFP02410</b>	<b>REV</b> <b>B</b>
			<b>APPD</b> IAN QUINN 21-AUG-01		<b>CODE:</b> 58982	<b>SCALE:</b> NONE	<b>SHEET</b> 1 OF 2

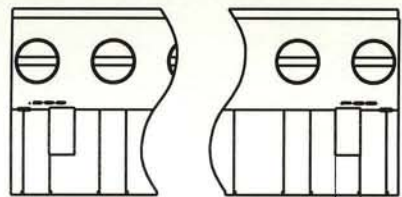

WITHOUT MOUNTING EARS

$$L = (\text{NUM OF POS} \times \text{CL}) - .1$$

2X.100  
2X.150

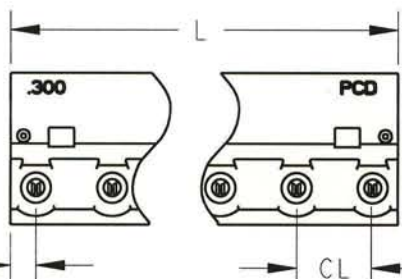

2X.100

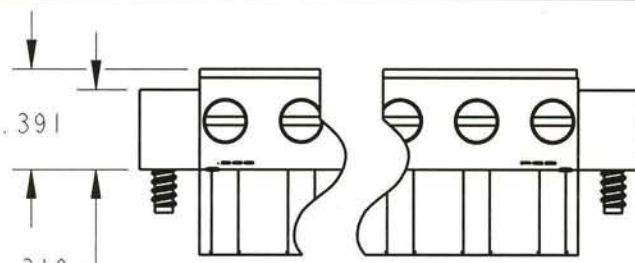
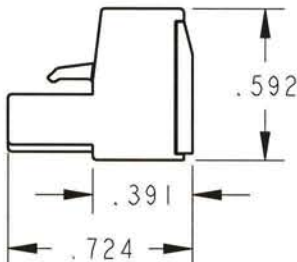

WITH MOUNTING EARS

$$L = (\text{NUM OF POS} \times \text{CL}) - .1$$

2X.310

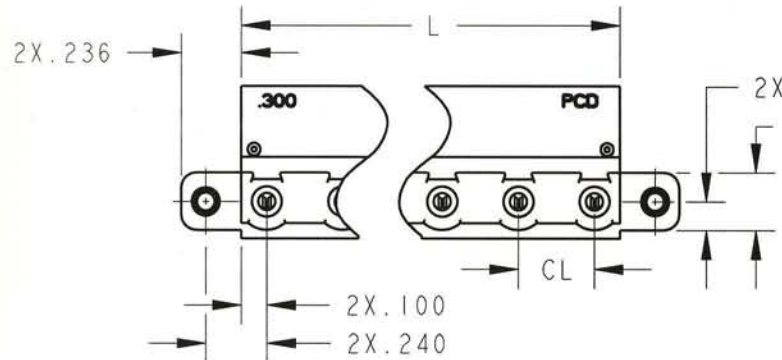

2X.236

2X.100  
2X.240

2X.112  
2X.224

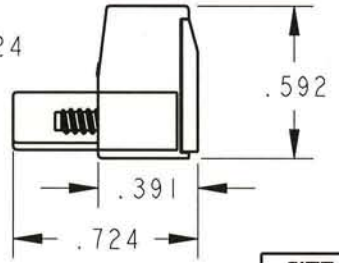

SIZE	DWG NO.	REV
A	ELFP02410	B
CODE: 58982	SCALE: NONE	SHEET 2 OF 2